

Clavijas de empotrar salida recta SpeedPRO | SpeedPRO straight panel plugs

SpeedPRO IP54 75x75 16A / 75x75 32A
Clavija de empotrar / Straight panel plug

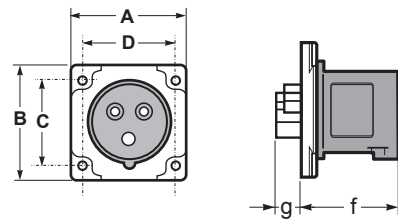

Poles	16A			32A		
	3	4	5	3	4	5
A	75	75	75	75	75	75
B	75	75	75	75	75	75
C	60	60	60	60	60	60
D	60	60	60	60	60	60
f	48	48	48	57	57	57
g	15	15	15	18	18	18
Connection type	Conexión por tornillo / Screw terminals					
Wire flexible (mm ²)	1-2,5			2,5-6		
Weight (g)	89	109	124	131	151	174

- Terminales con tornillo
- Material: PA6/ABS
- Contactos: Latón
- IP54** a prueba de salpicaduras
- With screw terminals
- Housing material: PA6/ABS
- Contacts: Brass
- IP54** Splashproof

SpeedPRO IP54 55x55
Clavija de empotrar / Straight panel plug

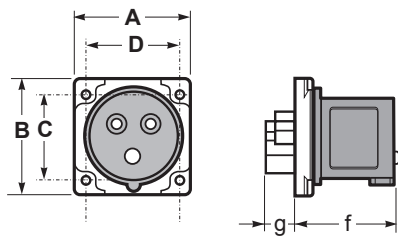

Poles	16A	
	3	4
A	55	55
B	55	55
C	44	44
D	44	44
f	48	48
g	15	15
Connection type	Conexión por tornillo / Screw terminals	
Wire flexible (mm ²)	1-2,5	
Weight (g)	89	109

- Terminales con tornillo
- Material: PA6/ABS
- Contactos: Latón
- IP54** a prueba de salpicaduras
- With screw terminals
- Housing material: PA6/ABS
- Contacts: Brass
- IP54** Splashproof

SpeedPRO IP67
Clavija de empotrar / Straight panel plug

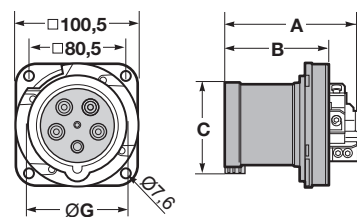

Poles	63A		
	3	4	5
A	270	270	270
B	114	114	114
C	175	175	175
G	14,5-34	14,5-34	14,5-34
Connection type	Conexión por tornillo / Screw terminals		
Wire flexible (mm ²)	6-16		
Weight (g)	585	600	620

- Terminales con tornillo allen
- Material: PA6/ABS
- Contactos: Latón con contacto piloto
- IP67** Hermético
- With Allen screw terminals
- Housing material: PA6/ABS
- Contacts: Brass with pilot contact
- IP67** Waterlight

3P = 2P + T
4P = 3P + T
5P = 3P + T + N

110V	230V	400V	500V
50/60Hz	50/60Hz	50/60Hz	50/60Hz

Amp	Poles	Pack unit	Poles: 3P 4P 5P	Poles: 3P 4P 5P	Poles: 3P 4P 5P	Poles: 3P 4P 5P
			Hour P: 4h 4h 4h	Hour P: 6h 9h 9h	Hour P: 9h 6h 6h	Hour P: 7h 7h 7h

Poles	3	4	5	110V	230V	400V	500V
				13531	13631	13374	13837
16	3	10		13531	13631	13374	13837
	4	10		13532	13632	13370	13831
	5	8		13537	13636	13371	13832
32	3	5		13533	13633	13375	13838
	4	5		13534	13636	13372	13833
	5	5		13538	13637	13373	13834



Poles	3	4	5	110V	230V	400V	500V
				13535	13634	13733	13839
16	3	10		13535	13634	13733	13839
	4	10		13536	13635	13731	13835



3P = 2P + T
4P = 3P + T
5P = 4P + T

Poles	3	4	5	110V	230V	400V	500V
				13546	13638	13376	13840
63	3	5		13546	13638	13376	13840
	4	5		13539	13639	13377	13841
	5	5		13540	13640	13378	13842

